

3rd Floor Sutherland House

CCT01-LAYOUT CCT INTERIORS

3rd FLOOR, SUTHERLAND HOUSE, 5-6 ARGYLL ST, LONDON, W1F 7TD

PRINTED - 07.10.09

DESIGNER - COLIN OWEN
PROJECT MANAGER- TBC



DO NOT SCALE FROM THIS DRAWING
ALWAYS CHECK DIMENSIONS
ALL DIMENSIONS IN MILLIMETERS

DRAWING NOTES:

- COMPUTER FLOOR THROUGHOUT
- BULKHEADS THROUGHOUT OF VARYING HEIGHT
- OVERALL CEILING HEIGHT 2.7m

APPROVED BY CLIENT

SIGNATURE & PRINT
REQUIRED

KEY:

	NEW: DOUBLE BONDED GLASS WITH 50% COMPLIANT MANIFESTATION		POWER: DOUBLE SOCKET NUMBER REPRESENTS AMOUNT OF SOCKETS
	NEW: SINGLE SKIN ETYLUS BULKHEAD WITH 50% COMPLIANT MANIFESTATION		DATA: DATA POINT NUMBER REPRESENTS AMOUNT OF POINTS
	NEW: TRIPLE SKIN ETYLUS PARTITION WITH 80% WOOL INSULATION		POWER-DATA: POWER - 3 DATA
	GLASS DOOR		POWER: FUSE SPUR
	STANDARD DOOR + POINT GRADE + PUSH OPENING		POWER: COMMAND SOCKET
	LIGHTING: - PENDANT		POWER-DATA: SOCKET MOUNTED
	LIGHTING: - HALOGEN		POWER: CLEANERS SOCKET FLOOR MOUNTED
	LIGHTING: - EXISTING PL - NEW LOCATION		
	LIGHTING: - EXISTING PL		
	LIGHTING: - EXISTING PL - TO BE REMOVED		
	LIGHTING: - STANDARD LIGHT SWITCH - BRUSHED METAL		
	LIGHTING: - DRAWER SWITCH - BRUSHED METAL		

FURNITURE:

ALL HANDLES ON ALL STORAGE TO BE AERO HANDLES

- MANAGEMENT CHAIR
- OPERATOR CHAIR
- BOARD ROOM CHAIR

HALOGEN LOCATIONS OUTSIDE THE MEETING ROOMS TO BE ON THE FLOOR & CEILING

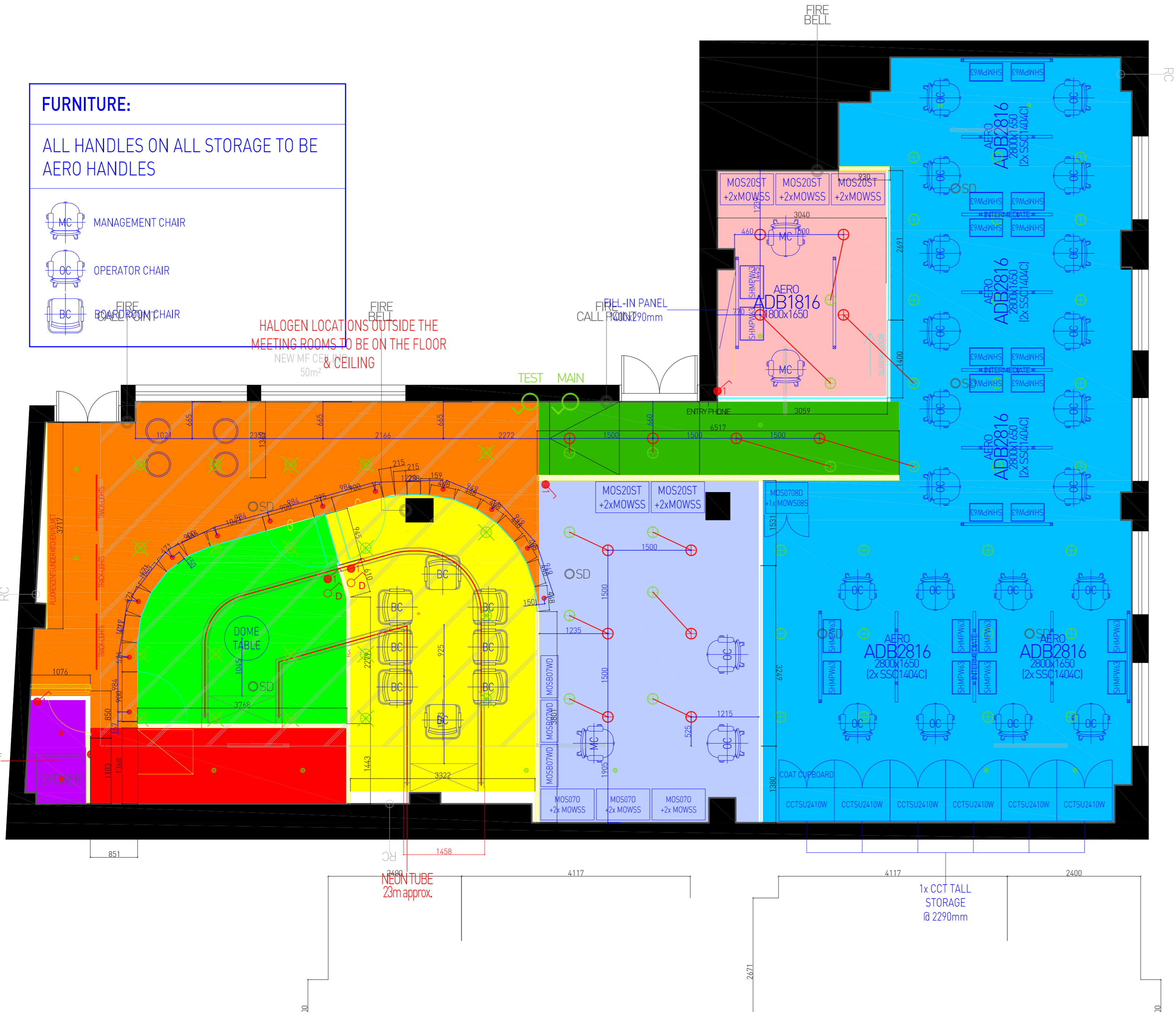

© DRAWING COPYRIGHT OF CCT OFFICE INTERIOR SOLUTIONS - Part of the CCT Group of Companies CANNOT BE DISTRIBUTED WITHOUT PERMISSION

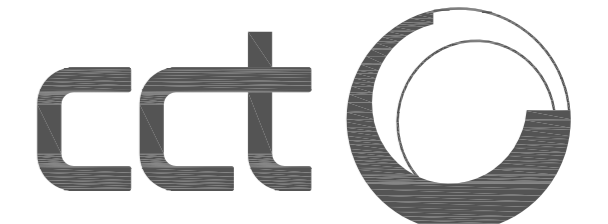

OFFICE INTERIOR SOLUTIONS

WWW.CCTINTERIORS.COM
Unit 9, Cannon Wharf, 35 Evelyn Street, London, SE8 5RT
Tel +44 (0) 845 30 31 301 Fax +44 (0) 845 30 31 302